

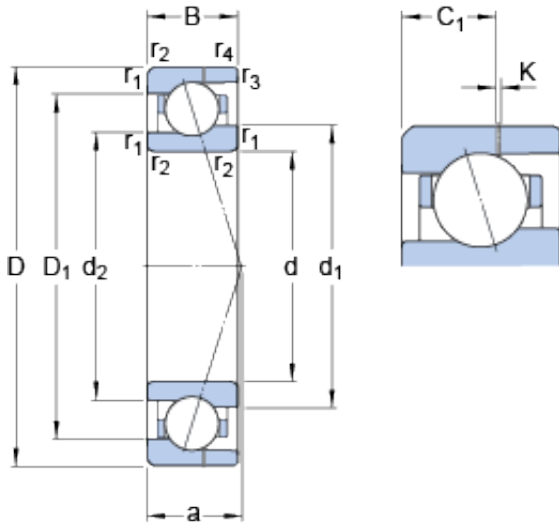

NTN PRECISION AXLE CORP.



10 mm x 22 mm x 6 mm SKF 71900 CE/HCP4AH angular contact ball bearings

Bearing No. 71900 CE/HCP4AH

71900 CE/HCP4AH Bearing 2D drawings and 3D CAD models

Size	22x10x6 mm
Bore Diameter	22 mm
Outer Diameter	10 mm
Width	6 mm
d	10 mm
D	22 mm
B	6 mm
d ₁	14 mm
d ₂	13.26 mm
D ₁	17.92 mm
K	0.5 mm
C ₁	3.65 mm
r _{1,2} - min.	0.3 mm
r _{3,4} - min.	0.15 mm
a	5.4 mm
d _a - min.	12 mm
d _b - min.	12 mm
D _a - max.	20 mm
D _b - max.	21.2 mm
r _a - max.	0.3 mm
r _b - max.	0.15 mm
d _n	14.8 mm
Basic dynamic load rating - C	2 kN
Basic static load rating - C ₀	0.815 kN



NTN PRECISION AXLE CORP.

Fatigue load limit - P_u	0.034 kN
Limiting speed for grease lubrication	123000 r/min
Limiting speed for oil lubrication	185000 mm/min
Ball - D_w	3.175 mm
Ball - z	11
G_{ref}	0.1 cm ³
Calculation factor - f_0	7.6
Preload class A - G_A	11 N
Preload class B - G_B	32 N
Preload class C - G_C	65 N
Calculation factor - f	1.03
Calculation factor - f	1
Calculation factor - f_{2A}	1
Calculation factor - f_{2B}	1.05
Calculation factor - f_{2C}	1.09
Calculation factor - f_{HC}	1.01
Preload class A	11 N/micron
Preload class B	17 N/micron
Preload class C	24 N/micron
d_1	14 mm
d_2	13.26 mm
D_1	17.92 mm
C_1	3.65 mm
$r_{1,2}$ min.	0.3 mm
$r_{3,4}$ min.	0.15 mm
d_a min.	12 mm
d_b min.	12 mm
D_a max.	20 mm
D_b max.	21.2 mm



NTN PRECISION AXLE CORP.

r_a max.	0.3 mm
r_b max.	0.15 mm
d_n	14.8 mm
Basic dynamic load rating C	2.03 kN
Basic static load rating C_0	0.815 kN
Fatigue load limit P_u	0.034 kN
Attainable speed for grease lubrication	123000 r/min
Attainable speed for oil-air lubrication	185000 r/min
Ball diameter D_w	3.175 mm
Number of balls z	11
Reference grease quantity G_{ref}	0.1 cm ³
Preload class A G_A	11 N
Static axial stiffness, preload class A	11 N/ μ m
Preload class B G_B	32 N
Static axial stiffness, preload class B	17 N/ μ m
Preload class C G_C	65 N
Static axial stiffness, preload class C	24 N/ μ m
Calculation factor f	1.03
Calculation factor f_1	1
Calculation factor f_{2A}	1
Calculation factor f_{2B}	1.05
Calculation factor f_{2C}	1.09
Calculation factor f_{HC}	1.01
Calculation factor f_0	7.6
Mass bearing	0.008 kg